

KINGS HILL

Newletter

## Welcome

I am delighted to be able to tell you that work has now begun on our new park. The groundworks are underway but, as we are at the mercy of the British weather, we cannot say for sure when this stage will be complete and planting can begin. All being well we are hoping it will be open by the end of next summer. We are also celebrating two amazing landscape awards – two golds and a best in Kent in the South & South East in Bloom competition, testimony to our landscape-first approach. As we go to print, we are close to publishing a book about Kings Hill's first three decades – and thank you to everyone who contributed to it. Copies will be available for purchase soon, all proceeds to go to our local charity, Royal British Legion Industries. Altogether it has been an excellent year at Kings Hill and, as this is our Christmas issue, may I take this opportunity to wish you all a Merry Christmas and Happy New Year.

### Andrew Blevins

UK managing director, Liberty Property Trust



# Park update



The new park will be planted with swathes of wild flowers

Now all the fine-tuning on the plans for the new Kings Hill park has been completed, the initial earthworks have begun, which will create the layout and contouring of the land.

It is hoped that this part of the work will be finished within the next couple of months but, said Liberty's Derek Lloyd who is responsible for the project, it is weather dependent.

"We will do our very best to keep to our schedule but obviously if it is very wet, or if the ground is frozen, work will have to stop temporarily until conditions improve."

Once the initial groundwork is finished, landscapers Coblands – who have helped secure two gold

medals and a 'best in Kent' in the South & South East in Bloom competition – will start planting bulbs, shrubs and trees.

Work is scheduled to start on the play area next spring, once the groundwork is complete and the planting is underway.

"We know how much people are looking forward to using the new park and, all being well, we hope it will be open for people to enjoy by the end of next summer," said Derek.

## IN THIS ISSUE...

- > Park overview
- > New exhibition
- > Awards for Kings Hill
- > Musical treat
- > Have your say
- > Christmas at Kings Hill

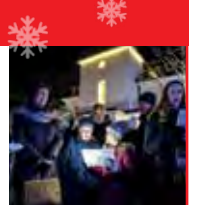



## Christmas present?

Over the past months Liberty has been putting together a book charting the development's evolution over the last three decades, from a flat airfield into the bustling community it is today.

Residents and businesses helped with the book by providing anecdotes and comments as well as taking part in photoshoots and the book is dedicated to all those who have helped create what was once just a developer's vision.

The cost is £10 and all proceeds on sales will go to Royal British Legion Industries, which is raising £14m to create a specialist Centenary Village for veterans and their families.

Copies will be available in good time for Christmas and details will be announced on the Kings Hill website.

"A huge thank you to all those who gave up their time to help us with the book," said Andrew Blevins. "It would make a great Christmas present while helping the veterans who are beneficiaries of the charity."

## Overview of the new park

Feature roundabout

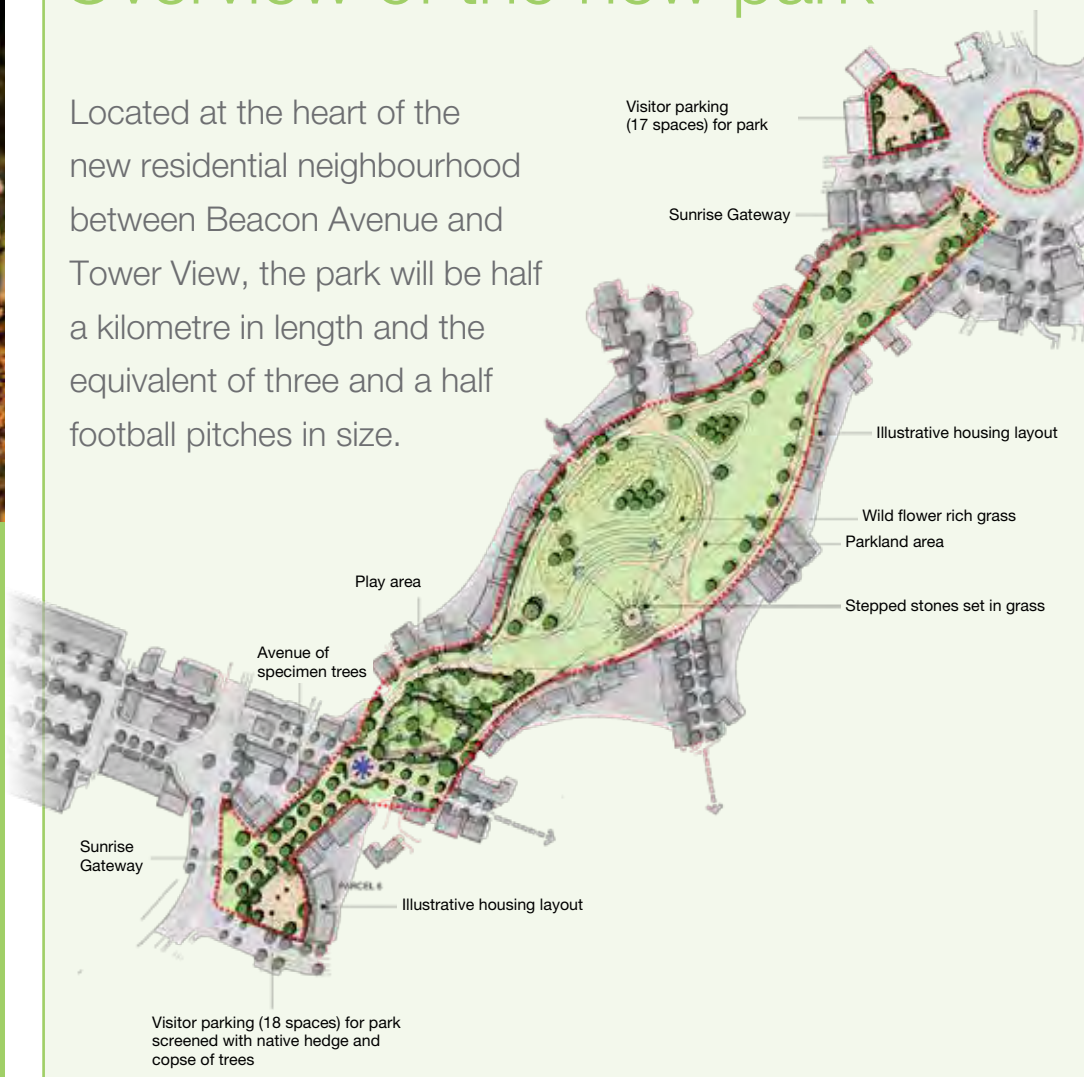

### Park layout

The park will be split into several distinct areas, featuring avenues of trees, a play area, natural parkland, sculptural mound, public art and cycle links.

There will be two entrances – one from Tower View linked to the village centre via a tree-lined avenue and

which will have a piazza and small car park, and the other from Beacon Avenue which will lead to an area of open space for casual play and leisure.

In the middle of the park will be a large sculpted grass mound with a landscaped seating area overlooking the rare World War II Pickett-

Hamilton fort, one of only a few remaining in its original location.

Throughout the park there will be a good variety of native and specimen trees, shrubs and swathes of wild wildflowers to provide year-round colour and interest as well as providing wildlife habitats.

## Colourful exhibition

An atmospheric and playful painting by an artist whose work has been recently featured in Tatler and House & Garden is among the exhibits in the brand-new art exhibition in the Control Tower.

The softly-coloured piece by Jemma Day is being exhibited alongside a decorative, contemporary glasswork

by Joe Szabo, a painting depicting the rolling hills of the South Downs by Loraine Hays abstracts capturing the light and atmosphere of the Cornish coast by Andrew Palmer.

Also there is an eye-catching painting showing how artificial intelligence can assist the creative process by Gabriel di Mauro.



'The sky outside me'  
by Jemma Day

The exhibition is open Monday to Friday between 9am and 5.30pm.



# Two golds and best in county

Kings Hill has been awarded two gold medals and been named best in Kent in this year's South & South East in Bloom competition

It won golds in the Town Centre and Business Landscape categories and the judges also gave it the discretionary Kent County award.

The judges were impressed by the high level of community involvement in creating the award-winning landscape, stating that it is very clear that people 'have such pride in the aesthetics of the whole place and enjoy contributing to that by doing their bit.'

Apprentice landscaper Connor Edwards, who works for Coblands, received a special mention for his hard work in the sensory garden at GenesisCare in the business park, adding that the high standard of the soft and hard landscaping in the business park made it a 'very desirable area for businesses to locate.'

"It is a real team effort and so exciting to have everyone's hard work recognised in this



**Poppies by the Control Tower**

way," said Liberty's Susan Davies, who is responsible for overseeing the landscaping with the help of ecologist Sue Deakin. "We couldn't do it without the help and support of the local community, clubs, groups, societies and the three schools.

"It is also a huge priority to be as ecologically and environmentally friendly as possible and this year local children have helped us create a series of bug hotels and wildlife habitats."



**Susan Davies (front right) with judge and the Coblands team**

## Have your say

Now that the new residential neighbourhood is well underway, Liberty and Kent County Council have been looking at the remaining land at Kings Hill and are proposing that all of it be devoted to residential use.

As usual, feedback from the community is welcome as plans are finalised prior to submitting the relevant planning applications.

A public consultation will be held at The Control Tower on Monday, 12 November, 11.00 am - 1.00 pm and 6.00 - 8.00 pm.



**Richard Harwood**

## Treat for music lovers

Music lovers were treated to virtuoso performances by acclaimed ensemble Chamber Domaine at a concert in the Control Tower recently. The event, which was sponsored by Liberty, was part of of Music@Malling - an international festival that brings 'outstanding' music to historic buildings in and around West Malling.

Discovery School also played a leading role in Music@Malling, welcoming children from 20 local primary schools for a performance of pieces from Michael Rosen's 'The Great Enormo' - an introduction to the orchestra for young people which encouraged interaction with 'musical fun and madness' and featured a narrator, orchestra, wasps and soprano.

# News in brief

- Two new play areas have been installed at the Sports Park with a trampoline and zip wire for older children and swings for younger children.
- Liberty is planning to resurface the Gibson Drive play area and replace the equipment. Works to install the new equipment will start in January 2019.

## Road closure 25 December 2018

Kings Hill Estate Management Company is required to close Kings Hill Avenue and Tower View for a 24 hour period from midnight on Christmas Eve to midnight Christmas Day to maintain the private status of the roads. Access to the residential development will be fully available via Gibson Drive. Visit [www.kings-hill.com](http://www.kings-hill.com) for more information.

### Office/Retail enquiries:

Caroline Binns  
Associate Director  
Marketing & Leasing

t: 01732 870375  
e: [cbinns@libertyproperty.com](mailto:cbinns@libertyproperty.com)

Liberty Property Trust UK  
The Control Tower  
29 Liberty Square  
Kings Hill, West Malling  
Kent ME19 4RG

### Commercial Property Management Helpdesk:

t: 01732 223420

[www.kings-hill.com](http://www.kings-hill.com)

# Christmas at Kings Hill

Keen ice skaters will be able to practise their lutz jumps, twizzles and chassés at the Sports Park this winter. The parish council has arranged for a small artificial ice rink to be installed during the Christmas holidays from 20 December to 3 January and are offering residents a discount on the ticket price.



## Other Christmas news



### Christmas past at Kings Hill

As usual Kings Hill will be at its festive best for Christmas with a twinkling tree in the centre of Liberty Square acting as the focal point for the community.

Carols around the tree will take place on Saturday 8 December at 5pm in the piazza outside the Control Tower, with the service conducted by the Rev Mark Montgomery. There will be a toy collection for the Salvation Army Christmas Present Appeal and anyone wishing to

donate should drop them off at the Vicarage, 19 Worcester Ave, or at the service on 8 December or the Toy Service on 2 December which will be at 10am at the Discovery School.

This year there will be a 'Follow the Star' Nativity rock hunt where people search for rocks painted with nativity scenes which will be spread throughout Kings Hill. It starts on 1 December and ends on 24 December when the final

piece will be revealed at the Messy Nativity Service at 4pm at the Discovery School.

Kings Hill Rotary Club is arranging for Father Christmas and his sleigh to be outside The Spitfire from 4-8pm on Saturday 8 December, collecting donations for charity. There will also be a charity Christmas hamper raffle at The Spitfire in the runup to this date, with the draw taking place at 6pm. Father Christmas will then be travelling around Kings Hill on Saturday 15 December between 4-8pm. Please refer to the club's Facebook and Twitter for the route.

Kings Hill Cricket Club is also joining in the fun and is organising a Christmas jumper night on Friday 14 December and a Christmas quiz on Friday 21st December.

The maintenance and quality of most of Kings Hill's residential neighbourhoods is the responsibility of the Kings Hill Residential Estate Management Company (KHREMC) which is a not-for-profit company.

It is managed by Liberty but has two residents as directors, John West ([john@westjj.net](mailto:john@westjj.net)) and Deborah Petty ([deb@khremc.com](mailto:deb@khremc.com)).

Kings Hill Residential Estate Management Company Ltd can be contacted on 01732 870375 or [kingshillresidential@libertyproperty.com](mailto:kingshillresidential@libertyproperty.com).

Kings Hill Estate Management Company Ltd, which is also a not-for-profit entity, looks after the commercial business park within Kings Hill.

## Log on for latest news

Our website [www.kings-hill.com](http://www.kings-hill.com) has information on all aspects of the development – maps; the masterplan; latest news; links to the Kings Hill amenities such as shops, restaurants, surgery etc; public transport timetables and information on matters that affect those living and working at Kings Hill.

